

DRAWING NUMBER

W2233-00

THIRD ANGLE PROJECTION

DO NOT SCALE

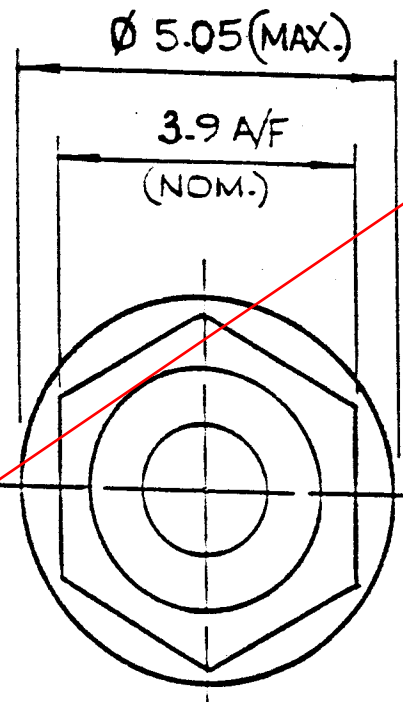
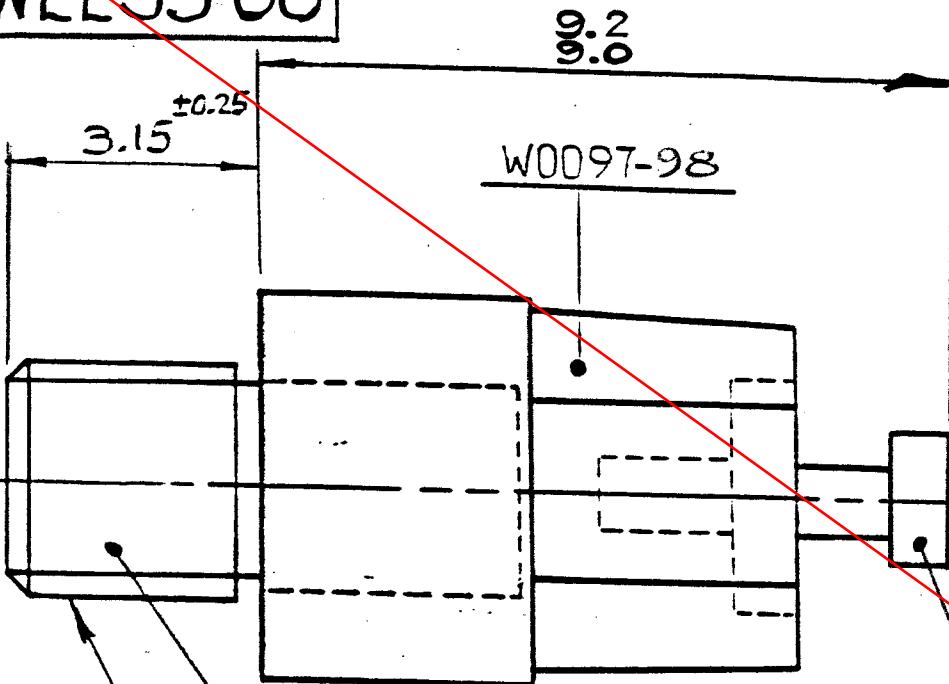

OBSOLETE

M2

X0070-02

INSERT TO WITHSTAND MINIMUM TORQUE REQUIREMENT OF 1.0 lb.f. IN Moulding.

X0080-01

WITHSTAND TURRET TO MINIMUM PULLOUT FORCE OF 2.4 lb.

2	9.6.89	1454
1	19/5/87	
ISS.	DATE	CHANGE
APPD.	<i>SK</i>	
CHKD.	J.C.	
DRAWN K.SHIER		
COMPUTER No.		
ASSY. DRAWING		

THIS DRAWING AND ANY INFORMATION OR DESCRIPTIVE MATTER SET OUT HEREON ARE THE CONFIDENTIAL AND COPYRIGHT PROPERTY OF HARWIN ENGINEERS S.A. AND MUST NOT BE DISCLOSED, LOANED, COPIED OR USED FOR MANUFACTURING, TENDERING OR FOR ANY OTHER PURPOSE WITHOUT THEIR WRITTEN PERMISSION.

HARWIN
 Harwin Engineers S.A.
 Fitzherbert Road - Farlington - Portsmouth - Hants - PO6 1RT
 Telephone: 0705 370451 - Telex: 86125

MATERIAL SEE DRG

TITLE S/TURRET ASSY
 M2 MALE (3.9 A/F)

TOLERANCES	
X	± 1mm
X.X	± 0.25mm
X.XX	± 0.1mm
X.XXX	± 0.01mm

FINISH	
S/AREA	mm²
DIM'S. IN MM	
SCALE 10 = 1	

DRAWING NUMBER
W2233-00